

BILL OF MATERIALS

ITEM	DESCRIPTION	QTY.
1	SS UPPER ROLLER 'Z' COVER	1
2	SS UPPER ROLLER 'Z' COVER REINFORCEMENT	1
3	SS LEFT HAND END CAP	1
4	SS RIGHT HAND END CAP	1
5	SS RIGHT END ANGLE	1
6	SS LEFT END ANGLE	1
7	SS 1" X 1 1/2" X 2 1/2" LG. TUBING	3
8	SS SLIDING DOOR TRACK	1
9	1/2-13 X 16" ALL THREAD (GALVANIZED)	1
10	SLIDING DOOR TROLLEY (GALVANIZED)	2
11	SS DOOR HINGE STRAP	2
12	SLIDING DOOR ASSEMBLY	1
13	SS TOP CAM	1
14	SS BACK UP PLATE	3
15	SS GUIDE PLATE (2) HOLES	3
16	GRAB HANDLE (ALUMINUM)	1
17	SS 1" Ø TUBING	1
18	SS SEAL PLATE FOR HANDLE	1
19	SS SEAL PIN FOR HANDLE	1
20	SS HANDLE	1
21	SS HANDLE MOUNT	1
22	SS RIVET 13/32 X 1 1/8	1
23	SS BOTTOM CAM	1
24	SS 1"Ø X 1 1/2" TUBING	1
25	SS 1/4" X 1" X 15 1/2" LG. FLAT BAR	2
26	SS 1/4" X 1" X 3" LG. FLAT BAR	2
27	SS 3/16" X 3" X 39" LG. PLATE	1
28	SS SLIDING DOOR PLATE (LIFT GATE APP.)	1
29	SS SLIDING DOOR PLATE (NO LIFT GATE APP.)	1
30	SS 5/16" BOLT	50

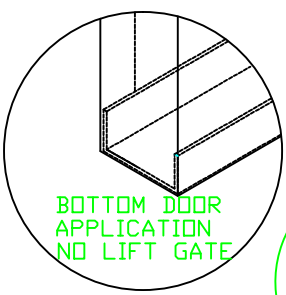
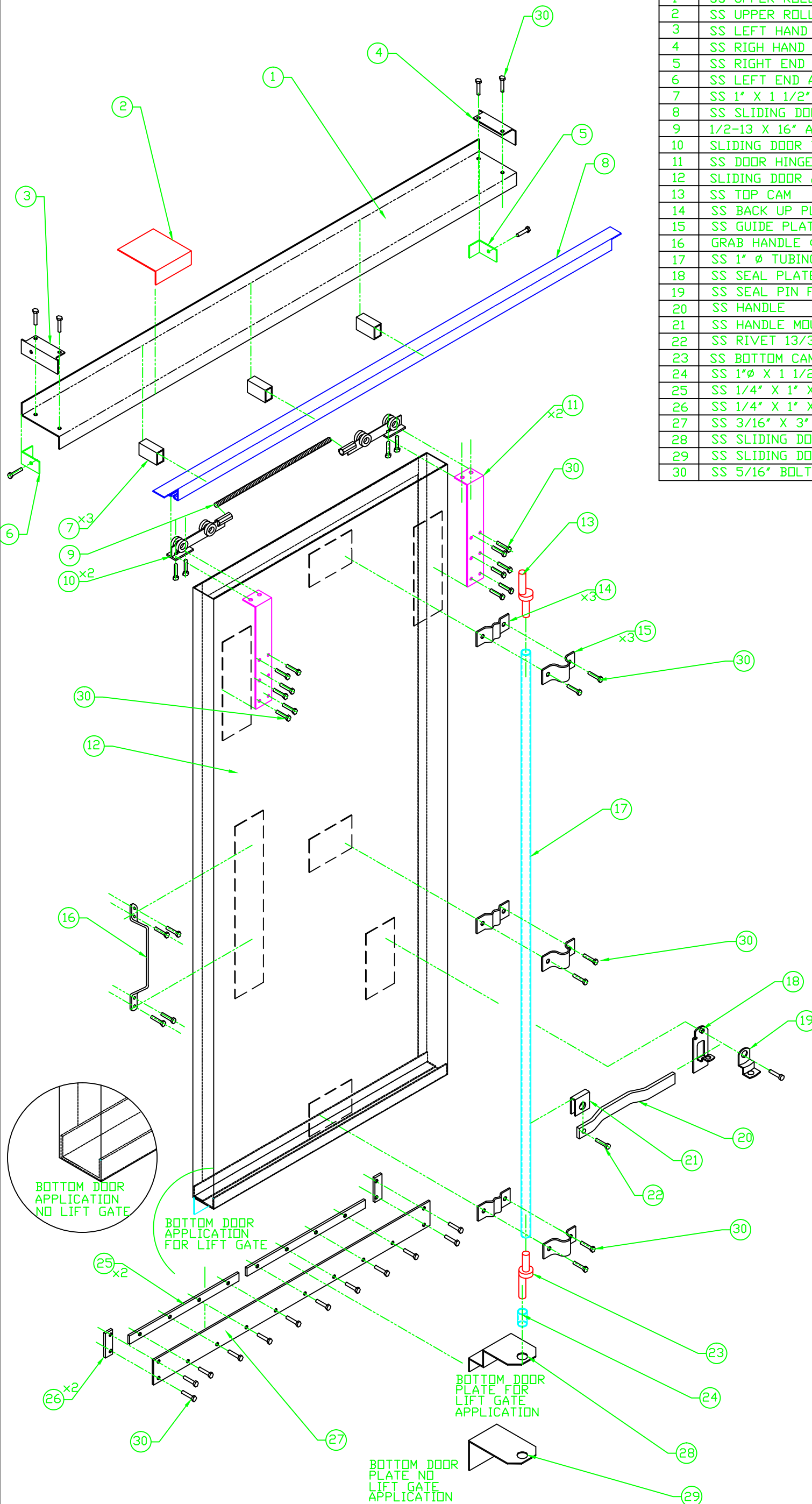

NAME SLIDING DOOR ASSEMBLY			DRAWN BY JEH	CHK BY	THIS DOCUMENT IS THE PROPERTY OF HERCULES MANUFACTURING. THE INFORMATION CONTAINED THEREIN IS CONSIDERED PROPRIETARY AND CONFIDENTIAL. THIS DOCUMENT IS NOT TO BE USED, REPRODUCED OR DISCLOSED IN WHOLE OR IN PART WITHOUT THE WRITTEN PERMISSION OF HERCULES MANUFACTURING.	HERCULES HENDERSON, KENTUCKY
MATERIAL	PART NO.	SHT OF	DATE 4/8/11	SCALE NTS		